

## PLUNGER ASSEMBLY INSTRUCTIONS

### Outside Plunger Assembly

Function AL40S

#### Disassemble Trim From Lock

1. Place a narrow tool into hole in inside lever to depress catch. Remove lever and driver. Repeat for outside lever and driver.

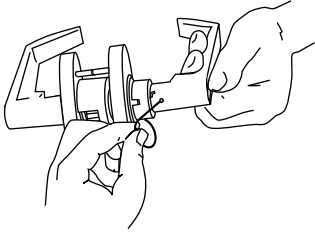

2. Rotate inside rose counterclockwise to remove from spring cage.

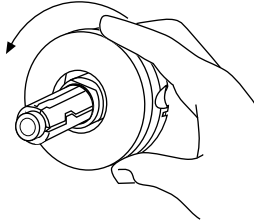

3. Using provided wrench, unscrew inside and outside castlenut bushings. Using Phillips screw driver, unscrew through bolts. Remove inside spring cage, anchor spring and outside rose and spring cage assembly.

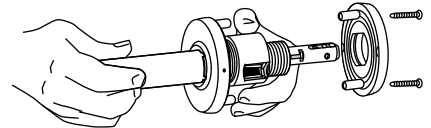

#### Disassemble Chassis

4. Remove chassis screws. Straighten lugs and remove housing from chassis. (If necessary, rap on edge of housing to loosen assembly.)

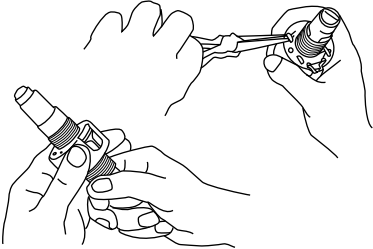

5. Depress slide, unhook and remove inside plunger and spindle.

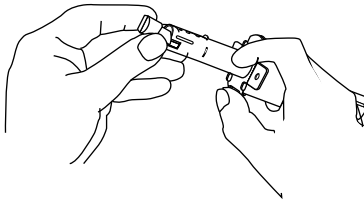

6. (Hold palms of hands around lock to prevent springs from escaping from slide.) Press forward with thumbs against frame tabs while pushing upward with index finger to disengage hub plate.

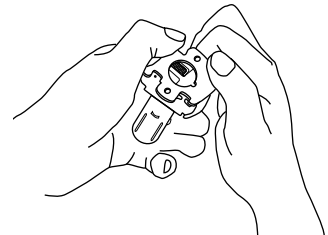

7. Remove slide and springs.

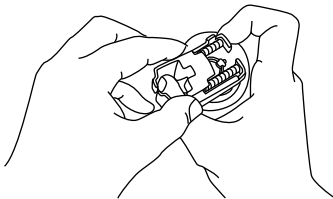

8. Remove cam from outside spindle.

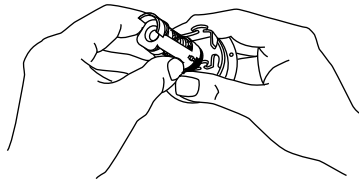

9. Use pliers to snap off outside button from plunger bar. Now remove the plunger bar.

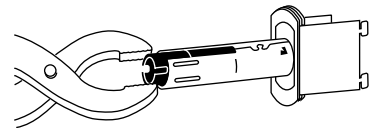

## Outside Plunger Assembly

Function AL40S

- 10.** To remove outside spindle, depress catch and push slide into hub and frame as far as it will go. Rotate spindle until catch aligns with slot in hub and plate. Depress catch again. Remove spindle.

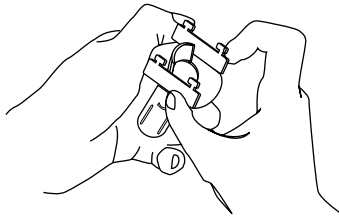

### Outside Button and Bar Assembly

- 11.** Insert outside spindle through lock frame from inside of frame. Insert plunger bar (less button assembly) into spindle as shown. The bar will stop against the catch in the spindle.

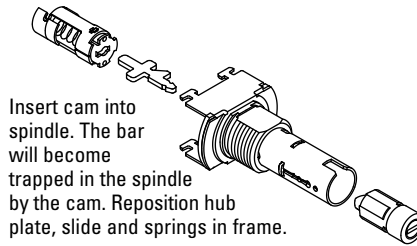

Insert cam into spindle. The bar will become trapped in the spindle by the cam. Reposition hub plate, slide and springs in frame.

- 12.** Install button assembly into spindle and snap firmly onto plunger bar. When properly assembled, rotating button will retract the slide.

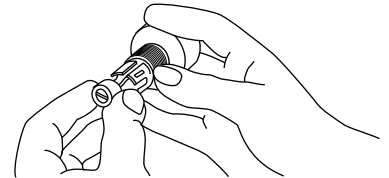

- 13.** Reverse steps to reassemble chassis and lock trim.

## Inside Plunger Assembly

Functions AL40S, AL50PD, AL53PD and AL85PD

Follow previous steps 1 thru 5 for disassembly of trim and chassis.

To remove outside lever of keyed functions, insert key into cylinder. Insert narrow tool into hole in lever. Turn key 90° and depress catch with tool. Pull off lever.

- 6.** Insert new plunger bar (less button assembly), depress slide and push plunger bar while releasing slide to hook into place.

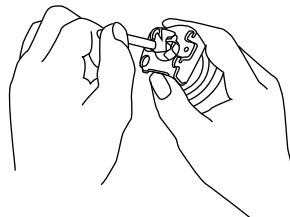

- 7.** Install spindle over bar, rotate slightly and push into place. Slot on spindle should be on same side as slide jaws.

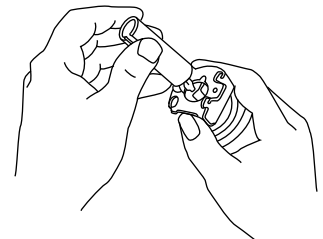

- 8.** Align plunger button assembly so lug fits into slot on spindle. Position plunger button assembly onto bar and snap firmly into place.

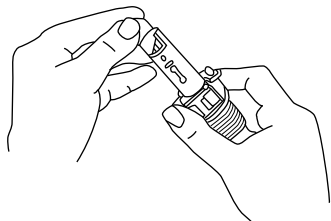

- 9.** Reverse steps to reassemble complete-lock and trim.